

PASQUOTANK COUNTY RURAL OWNERSHIP

TOWNSHIP NIXONTON

RURAL MAP No. P-91

TEMPORARY PARCEL NO.	GRANTOR RECORDED OWNER	GRANTEE RECORDED OWNER (BY DEED)	DEED OR WILL BOOK NO.	PAGE NO.	LEGAL LOT NO.	LEGAL PLAT NO.	LOT SIZE OR ACREAGE	GRANTEE	D. B. & P.	GRANTEE	D. B. & P.
									DATE		DATE
1	8912(02) 89 5109 CATHERINE COLEMAN	ERVIN + DORIS McPHERSON	455 223	598 417			10.25 10.05 AC	85CVD90 McPherson, Doris (90.E-15)	455-598 2-23-917 FOR 1990	THE APOSTOLIC FAITH CHURCH OF THE LORD JESUS CHRIST OF	582-50 9-27-95
1A	8912(02) 89 1045 IRVIN + DORIS McPHERSON	SANDRA M. PERRY	452	145			120 X 156 (43+) LOT	STEVENSON, THOMAS F. SR.	575-205 4-12-95	LUTHER'S NC PROPERTIES LLC	1168-9 3-18-13
2	8912(02) 89 2303 IRVIN + DORIS McPHERSON	CHURCH OF THE APOSTOLIC FAITH, INC.	188 295	509 415			210' X 172' 210' X 156'	annexed INTO city 12-31-99			
3	8912(02) 88 5657 RODNEY-FOREMAN LUMBER CO.	TIMBER, Inc	238	244			7.15 AC.	J.W. JONES LUMBER Co., Inc	380-463 3-14-77	PEDRO + MARLENE HOLLEY	462- 2-14-2
4	8912(02) 88 4453 8655 FOREMAN MFG. Co.	GEORGE REID OVERMAN	237	217	2		2.00 1.07 9.5 AC.	PEDRO + OLLIE W. HOLLEY	461-494 12-19-85	FEREBEE, Wm H. & EFFIE WHITE-ETAL	587-496 1-30-95
4A	8912(02) 78 6677 GEORGE REID OVERMAN	S. K. + RUTH LOWERY	2-1-85 453	810			1.05 AC.	Lowery, S.L. & Ruth S	513-563 1-10-71	LOWERY, S.L. & RUTH S. HEIRS	513-563 For '97
5	8912(02) 87 5873 CHARLOTTE G. FEARING	M.B. SR. + GRACE BROTHERS	141	324			30.08 AC.	GRACE B. BROTHERS	Willed FOR 1983	ELIZ. City Airport Ind. Park Inc.	470-1 10-30
6	8912(02) 86 1785 CLARENCE HARRELL ETAL	Billy P. + ANNETTE HARRELL	330	246			234' X 210' LOT	Billy P. HARRELL EFFIE WHITE	432-726 11-23-81	LARRY R. + CATHY ALBERTSON	468- 9-11
4B	from p91.4 8912 02 78 8510	FEREBEE, Wm H. & EFFIE WHITE-ETAL	FOR 2000' 587	496	1		0.89 AC	FEREBEE, WILLIAM HENRY &	UNRECORDED PLAT-TAX OFF 676-1011 10-12-00	WELLS FARGO Bank, NA	1081-30 4-20-10

PASQUOTANK COUNTY RURAL OWNERSHIP

MAP No. _____

LOT	GRANTEE	D. B. & P.	GRANTEE	D. B. & P.	GRANTEE	D. B. & P.	GRANTEE	D. B. & P.	GRANTEE	D. B. & P.
		DATE		DATE		DATE		DATE		DATE
1										
1A										
2										
3	DELETED - INTO SUBDIVISION									
4	AMBER BAULFT. WHITE, CRAIG AUSTIN & PARRELL, GEORGE R. & CAROLYN S. GRAY, CHARLES R. & FAYE H.	676-1008 10-12-00 607-604 4-4-97	SELF-HELP VENTURES Fund DELETE THIS PARCEL FOR 99' added TO P91-27	1060-290 7-22-09	STEVENSON Sand INC	1277-703 3-23-17	PARSONS, Steven R.	1427-643 10-12-21	Pamela Sue Progers, Brandon Wayne &	1448-699 04-12-20
5										
6	Shorn, Walter Sr 1121-564 4B Housing & URBAN Dev.	519-238 8-13-91 1095.115 10-6-10	LORI DORA MCGRONAN KIRBY, CARL EDWARD & WALTON, TODD J.	674-427 8-22-00 1122-192 10-7-11	LORI MCGRONAN KIRBY, CARL EDWARD &	918-899 6-7-06	KIRBY, CARL Edward	1218-145 1-6-15	ALICIA KIM 1311-811 9-25-18 WHITE, ARNOLD JEROME SR &	

PASQUOTANK COUNTY RURAL OWNERSHIP

TOWNSHIP NIXONTON

RURAL MAP No. P-91

TEMPORARY PARCEL NO.	GRANTOR RECORDED OWNER	GRANTEE RECORDED OWNER (BY DEED)	DEED OR WILL BOOK NO.	PAGE NO.	LEGAL LOT NO.	LEGAL PLAT NO.	LOT SIZE OR ACREAGE	GRANTEE	D. B. & P.	GRANTEE	D. B. & P.
									DATE		DATE
6A	8912(02)77 9181 SEE P91-34	Billy P. + ANNETTE HARRELL	330	246			10.0 11.21 11.06 AC	Billy P. HARRELL	432-726 11-23-81	RIVERVIEW Est. Dev. Co.	498-646 7-31-89
6B	8912(02)76 9786 Billy P. + ANNETTE HARRELL	HURDLE + WEBB CONST. Co. Inc	456	580			82 100 AC LOT	Wm. F. + SALLIE BRCKHOUSE	459-339 9-13-85	LISOWSKI, LINDA R. + JOSEPH A. E.	841-234 2-14-05
7	8912(02)86 6928 CLARENCE HARRELL etal	Billy P. + ANNETTE HARRELL	330	246	2		10.00 11.06 AC	Billy P. HARRELL	432-726 11-23-81	RIVERVIEW Est. Dev. Co.	498-646 7-31-89
7A	8912(02)86 4706 Billy P. HARRELL	DELBERT P. + CAROLYN CREEF	460	295			LOT	07-E-145 CREEF, DELBERT	460-295 FOX 2008		
8	? 8912 02 96 3958 2799 MATTIE H. BAILEY etal	FRANK + NANNIE H. JENNINGS	324	450	3		8.38 4.28 2.72 11.06 AC	CLARENCE HARRELL JENNINGS	408-72 4-3-79	VESTEL B. PENDLETON, RICHARD WAYNE E.	609-446 512-97
9	? 8922 07 0068 2853 CLARENCE HARRELL etal	Billy P. + ANNETTE HARRELL	330	246	4-10		11.23 13.78 12.13 15.30 AC	Billy P. HARRELL	432-726 11-23-81	MANNING, RICHARD H. + DEBORAH S.	576-729 5-19-95
9A	8912(02)96 7798 Billy P. HARRELL	RICHARD H. + DEBORAH MANNING	460	292			LOT				
9B	8922 07 3363 HARRELL, BILLY P.	PASQUOTANK COUNTY	581	389			.52 AC				
9C	8922 07 3036 MANNING, RICHARD H. + DEBORAH S.	ELIZABETH P. HARRELL	607	805	Tract 1		1.12 1.65 AC	HARRELL, BILLY P.	642-842 1-8-99	HARRELL, BILLY P. HEIRS	642-842 FOX 2002
8A	From P91-8 VESTEL B. 8912 02 96 3958 PENDLETON, RICHARD WAYNE E.	MANNING, RICHARD H. + DEBORAH S.	644	780	6		8.46 4.10 AC				
8B	8912 02 97 0382 PENDLETON, RICHARD WAYNE E.	VESTEL B. RICHARD WAYNE E.	609	446	1		1.0 AC	PENDLETON, VESTEL B.	645-612 2-23-99	PHYLLIS G. BROOKS, RICKEY R. E.	788-854 1-8-04
8C	8912 02 96 1949 PENDLETON, RICHARD WAYNE E.	VESTEL B. RICHARD WAYNE E.	609	446	2		.78 AC	PENDLETON, VESTEL B.	645-612 2-23-99	PHYLLIS G. BROOKS, RICKEY R. E.	788-854 1-8-04
8D	8912 02 96 0881 " " " "	" " " "	609	446	3		1.03 .72 AC	PENDLETON, VESTEL B.	645-612 2-23-99	D & R CONSTRUCTION CO JAMES, RONALD L. d/b/a	689-514 5-8-01
8E	VESTEL B. 8912 02 96 3789 PENDLETON, RICHARD WAYNE E.	RICHARD GRANT INC	692	611	5		.72				
9D	From P91-9 FOX 2007 576-729 8922 07 0068 MANNING, RICHARD H. + DEBORAH S.	CRAIG S. UMPHLETT, MEREDITH M. E.	897	112			11.00 AC				

PASQUOTANK COUNTY RURAL OWNERSHIP

LOT	GRANTEE	D. B. & P.	GRANTEE	D. B. & P.	GRANTEE	D. B. & P.	GRANTEE	D. B. & P.	
		DATE		DATE		DATE		DATE	DATE
6A	Fletcher Perry, Hurdle	535-468 11-16-92	transferred into subdivision for	1995					
6B	Ulysses Edwards, Shaquana	1501-908 12-15-23							
7	Fletcher Perry, Hurdle	535-468 11-16-92	transferred into subdivision for	1995					
8	RICHARD GRANT INC	692-591 6-19-01							
9C	DABCON INC	914-118 5-12-06	Bretters Ivy I	1325-496 12-1-18					
8B	Brooks Phyllis G.	1188-854 Feb 2021	Jackson Louise	11403-26 04-01-21					
8C	Brooks Phyllis G.	1188-854 Feb 2021	Allen, Terry T.	1399-921 03-08-21					
8D	Muhammad, JOHN & LEONETTA	699-221 9-14-01	WACHOVIA BANK, N.A.	1067-131 10-19-09	Timothy M. ZOLLARS, THERESA J. E	1081-79 4-16-10	U.S. Bank NATL ASSOCIATION	1267-1 10-20-16	VETERANS AFFAIRS 1268-200 11-3-16

PASQUOTANK COUNTY RURAL OWNERSHIP

TOWNSHIP Nixonton

RURAL MAP No. P91

TEMPORARY PARCEL NO.	GRANTOR RECORDED OWNER	GRANTEE RECORDED OWNER (BY DEED)	DEED OR WILL BOOK NO.	PAGE NO.	LEGAL LOT NO.	LEGAL PLAT NO.	LOT SIZE OR ACREAGE	GRANTEE	D. B. & P. DATE	GRANTEE	D. B. & P. DATE
See below 10	8922 07 7241 Mattie H. Bailey et al	Elizabeth P. Harrell	325	12	unrec'd plat	40-24	1.357 AC	Parcel deleted For 2007 combined with P91-9c & P91-10D			
11	8922 16 4658 Mattie H. Bailey et al	Mattie B. Harrell Bailey Heirs	36 N.D.F.	158			Lot	John H. & Catherine Ludford	412-280 7-13-79	Ludford, John L. & Katherine E.	509-1 6-1-90
11A	8922 16 2658 Mattie H. Bailey Heirs	James L. & Ann Cartwright	7-2-79 411	403		"	Lot	McNeill, Jennifer O. & Carey W. Jr.	1027-451 7-30-08		
12	8922 17 3028 Elizabeth Harrell et al	John L. & Catherine H. Ludford	324	398	6-9	580-808	5.315 AC	Billy P. & Annette Harrell	383-139 5-26-77	Billy P. Harrell	576-720 432-726 11-23-81
12A	8922 17 4502 Elizabeth Harrell et al	John L. & Catherine Ludford				49-43	4.18 AC	Ludford Lane LLC	452-876 1-16-07	Perkins Lane LLC	1003-690 1-4-08
13	8922 17 7034 Mattie H. Bailey et al	John L. & Catherine H. Ludford	313	433	Tract 2 7	49-45 47-14 40-42 49-43	1.1 AC	Kuszmar, Phyllis Ludford	93-E-34 501-1 For 96	Perkins Lane Partnership	674-480 8-23-00
14	8922 17 8094 Mattie H. Bailey et al	Frank H. & Nannie Jennings	322	229		"	3.5 AC	Parchment, Harlon Ansley Jr. & Jane Mary	580-348 8-14-95	Parchment, Harlon Ansley Jr.	623-899 2-20-98
15	8922 26 0621 James A. & Anna Harrell	Henry C. & Barbara Owney	255	274		51-49	2.79 AC	Owney, Barbara	255-274 For 2009	owney, BARBARA H. LF EST.	1224-277 4-8-15
10A	8922 07 4350 Harrell Elizabeth P.	Pasquotank County	8-28-89 499	404		499-404	Lot				
10B	8922 06 5872 Harrell Elizabeth P.	Owney, Lee A. & Vickie W.	904-154 553	16	2	34-49 553-17	1.62 3.17 AC	Owney, Vickie W.	553-16 Feb 2021	Martinez, Christal L. & Brock & White	1470-388 11-03-88
12B	8922 17 1037 Manning, Richard H. & Deborah S.	Fleming, Wesley R. & Beth O.	8-25-95 580	816	2	580-817	5.32 AC	HALL, Lindsay	1250-789 7-4-16		
From P91-10 10C	8922 06 7822 Harrell, Elizabeth P.	Marshall, Arlene Owney	8-7-97 613	816	1	34-49 613-867	1.67 AC	Satterfield, James Astry	1410-807 05-28-21		
10D	8922 06 2749 Harrell Elizabeth P.	Harrell, Billy P.	3-4-98 624	710	Tract 2	40-24	1.05 AC	Owney, Barbara H. et al	900-365 692-253 6-15-01	Dabcon Inc.	914-118 5-12-06
From P91-10 10E	For 2004 8920 07 9162 Harrell, Elizabeth P.	Harrell, Thomas P. & Dara H.	811-831 2-18-03 747	160		747-162	3.34 AC	HARRALL, Thomas P.	1131-941 2-15-12	HARRELL, Thomas P. & Joy OLIVER	1317-239 8-13-18
From P91-13 13A	For 2009 8922 17 5533 Perkins Lane LLC	Pasquotank Co. & City of EC.	12-31-08 1039	257	Tract 1	49-45 49-43	6.74 AC	Deleted For 2010 combined with P123-1E			
From P91-10B-1	For 2023 8922 07 2310 Owney, Vickie W.					70-1	1.52 AC				

Garden Printing Co. 338-8452

PASQUOTANK COUNTY RURAL OWNERSHIP

TOWNSHIP Nixonton

RURAL MAP No. P91

TEMPORARY PARCEL NO.	GRANTOR RECORDED OWNER	GRANTEE RECORDED OWNER (BY DEED)	DEED OR WILL BOOK NO.	PAGE NO.	LEGAL LOT NO.	LEGAL PLAT NO.	LOT SIZE OR ACREAGE	GRANTEE	D. B. & P. DATE	GRANTEE	D. B. & P. DATE
16	8922 37 0187 Mattie H. Bailey etal	Elizabeth P. Harrell	325	12	8	unrecorded Plat Tax off 51-49	2.79 AC	Henry C. & Barbara Owey	457-523 7-29-85	Owey, Michael C. & Sandra D.	810-667 6-30-04
17	8912 02 974682 Clarence Harrell etal	Billy P. & Annette Harrell	330	246	12	"	4.36 AC	Harrell, Billy P.	642-842 1-8-99	Harrell, Billy P. Heirs.	642-842 For 2002
18	8912 02 979535 Clarence Harrell etal	Billy P. & Annette Harrell	330	246	11 & 12	607-806 25-22 35-25	6.73 AC	Harrell, Billy P.	642-842 1-8-99	" " "	642-842 For 2002
19	8922 16 9301 Alethia Owens etal	James & Becky Owens	274	183		274-185	145' X 300'	Owens, Becky W.	274-183 For 2004		
20	8922 15 9530 W.R. & Nannie Lambert	Mrs. J.E. Owens (Heirs)	610 46	89 504	# B	25-39	31.77 AC	Jean Owens Jordan & Barkley Janet Owens	98-SP-33 For 2002		
20A	8922 15 3143 W.R. & Nannie Lambert	Mrs. J.E. Owens (Heirs)	46	504		25-39 610-589	1.23 AC	M.R. & Janet O. Barkley	362-491 6-16-75	Martatis, Cathy Weaver Richard William	610-588 6-3-97
21	8922 06 3042 J.H. Small Comm	John L. & Katherine Ludford	192	500		Annexed into City 2-1-06 41-8 40-15 9071344 20-07 42.47 AC		Perkins Lane Partnership	674-480 8-23-00	merged with sec. of state (12-27-01) Down East Dev. of N.C. LLC	895-313 1-13-06
21-A	8922 06 0494 Warren D. & Linda Jo Weeks		391	418			Lot				
22	8912 (02) 96 5200 Floyd P. Chiverval	Hilda P. Temple	2-23-73 341	311		Annexed into City 2-1-06 54-21 41-6	21.63 AC	Floyd P Chiverval LFB Est	341-311 For 1985	Hilda P. Temple	341-311 For 1987
20B	8922 14 5832 Mrs. J.E. Owens Heirs	Beth D. Owens	5-23-83 466	49			1.0 AC				
21B	8922 06 2553 Kusmar, Phyllis Ludford	Perkins Lane Partnership	12-2-94 570	314			1 AC	Twine, Steve	828-800 11-8-04		
20C	8922 16 7348 Owens J.E. Mrs (Heirs)	Owens J. Melvin Jr. & Becky W.	943-214 943-218 98	141		42-49 641-142	1.44 AC	Owens, Becky W	For 2004		
18A	From P91-18 8922 07 5540	Harrell, Billy P.	For 2000 642	842	# B	35-25 25-22	2.08 AC	Harrell, Billy P. Heirs	642-842 For 2002	Deleted Parcel For 2005 Combined with P91-18	
18B	8922 07 8465	" "	"	"	# C	25-22	2.08 AC	Harrell, Thomas Parker's Daughter	658-12 6-2-99	Boyd, Earl E.	750-456 3-17-03
20D	From P91-20 8922 16 6405 Owens J.E. Mrs. (Heirs)	Madden, Kent E. & Virginia M.	9-6-00 675	153		678-627 11-5 25-39	1.50 65 AC	Barnd, Christopher & Sabrina	1501-870 12-14-23		
20E	8922 26 3149 " " "	Owens, Eddie P.	For 2002 98-SP-33		# C	25-39	2.0 AC	Cherry, Ann D. ETAL	18-6-38 For 2021		
20F	8922 15 5650 " " "	Owens, Melvin Jr.	For 2002 98-SP-33		# A	25-39	30.43 AC				
20G	From P91-20D 8922 16 5235	Madden, Kent E. & Virginia M. etal	2-6-01 682	806		42-49 678-627 11-5	7.50 AC	Madden, Kent E. & Virginia M. ETAL	1355-406 01-03-2020	Madden, Kent & Virginia	682-806 For 2002

PASQUOTANK COUNTY RURAL OWNERSHIP

MAP No.

P91

LOT	GRANTEE	D. B. & P. DATE	GRANTEE	D. B. & P. DATE	GRANTEE	D. B. & P. DATE	GRANTEE	D. B. & P. DATE
16	CHENEY, JULIE S.	1084-98 5-20-10	CLARK, VERNON W. & KEVIN B.	1330-169 2-27-19				
17	Parcel deleted & Combined with P91-8A For 2004'							
18	Luther, Annette	812-685 7-15-04						
19								
20								
20A	Lewis, Aniceta B. & Clarence L. 895-313	741-1 7-28-03						
21	Perkins Lane LLC	Merged For 2010	BACCUS, GILBERT R. & SYBIL H.	1118-164 8-16-11	MEADS HOME BUILDERS INC	1240-876 11-12-15	PBC of Perkins Estates, LLC	1444-655 03-09-22
21A								
22	Temple, James Leroy	89-E-16 For 1989	Perkins Lane LLC	884-657 11-4-05	Parcel Combined with P91-21 For 2010			
20B								
21B								
20C								
18A								
18B	Spencer, Holly J.	1032-310 9-24-08						
20G	Baird, Christopher & Sabrina	1489-712 07-11-23						

PASQUOTANK COUNTY RURAL OWNERSHIP

TOWNSHIP NIXONTON

RURAL MAP No. P-91

TEMPORARY PARCEL NO.	GRANTOR RECORDED OWNER	GRANTEE RECORDED OWNER (BY DEED)	DEED OR WILL BOOK NO.	PAGE NO.	LEGAL LOT NO.	LEGAL PLAT NO.	LOT SIZE OR ACREAGE	GRANTEE	D. B. & P.	GRANTEE	D. B. & P.
									DATE		DATE
23	8912(02)86 0035 T. E. + ELIZABETH STEVENSON	Thomas Edward STEVENSON	212	358			37.85 33.24 38.93 AC.	212-358 STEVENSON, RACHEL MARIE CARTER	97-E-214 FOR 98'	212-358 WHITE, BETSY ANN STEVENSON	97-E-214 FOR 2001'
23A	8912(02)86 6530 Thos. Edward STEVENSON	GARY G. + BETSY WHITE	428	197			226' x 192'				
24	8912(02)75 H. A. REID CHARLOTTE G. FEARING	NAT DAVIS	350	472			2.64 AC	DAVIS, MARGARET C.	495-305 4-7-89	DAVIS, DAVID W.	714-782 3-22-02
25	8912 83 8603 94 6805	William B. MEADS HEIRS	N.D.F.	300			310.77 51.55 200.00 AC.	MEADS, Timothy A + Sherry	473-828 3-6-87	918-915; 994-147 MEADS, WILLIAM B. III &	510-653 9-19-90
25A	8912 84 7995 Wm. B. MEADS HEIRS	Wm. B. MEADS, JR. + Joyce	12-30-76 379	347			220' x 400' LOT	meads, William B Jr	533-848 10-12-92	HEATHER S. MEADS, WILLIAM B. III &	1157-772 11-21-12
25B	8912 94 0887 William B. MEADS HEIRS	Clifton E. + Joanna White	7-24-85 457	467	Tract B	58-22	2.12 5 AC.	WHITE, JOANNA R. LF EST.	1220-437 2-16-15	Higgins, Rebecca M.	1220-437 FOR 2024
25C	8912 83 8603 M & W HOG FARMS	WILLIAM B. JR. BATEMAN, MICHAEL T. &	7-24-96 596	146			162.65 AC	Amy BATEMAN-CO TR BATEMAN, MICHAEL T. & Linda W.	1163-432 1-29-13	Farmland TR. BATEMAN, Michael T.	1283-60 5-25-17
23B	891202756510 STEVENSON, RACHEL MARIE CARTER	STEVENSON, THOMAS E. JR.	10.57-407 FOR 2001'	97-E-214			4.90 4.80 AC				
25D	91-25 FOR 2009 M & W HOG FARMS	MEADS, JASON BRYANT	5-5-08 1017	881			2.12 AC	DELOSREGES, MARK & NICOLE	1162-729 1-18-13		
25E	8912 857103 M & W HOG FARMS	JAMES WESLEY HIGGINS, REBECCA MEADS &	5-5-08 1017	877			2.13 AC				
25B-1	91-25B FOR 2016 WHITE, CLIFTON E. & JOANNA	MEADS, JASON BRYANT	2-16-15 1220	434	Tract A	58-22	3.07 AC				
25B-2	91-25B-1 FOR 2018 meads, Jason Bryant	MEADS Jason Bryant & Erica G.	0806-21 1419	208			1.31 AC				
25B-3	91-25 FOR 2020 Higgins, Rebecca M. & James Wesley	Sawyer, Natalie Higgins	9-10-19 1345	734			2.26 AC	Sawyer, Natalie H. & Trent J.	1259-108 2-21-2020		
25F	91-25 FOR 2025 Higgins, Rebecca M. & James Wesley						14.81 AC.				

PASQUOTANK COUNTY RURAL OWNERSHIP

OWNSHIP NIXONTON

RURAL MAP No. P-91

TEMPORARY PARCEL NO.	GRANTOR RECORDED OWNER	GRANTEE RECORDED OWNER (BY DEED)	DEED OR WILL BOOK NO.	PAGE NO.	LEGAL LOT NO.	LEGAL PLAT NO.	LOT SIZE OR ACREAGE	GRANTEE	D. B. & P. DATE	GRANTEE	D. B. & P. DATE
26	8912 74 3699	CHARLOTTE G. FEARING	39	158	TRACT 3	11-18	33.78 133.5 130.45 28.86 136.0 AC.	ALBEMARLE FARMS.	418-316 2-27-80	VERNON G. JAMES	470-492 2-17-86
26A	8912(02) 85 0370 ALBEMARLE FARMS	DALLAS JAMES LANE	451	332	TRACT 5	11-18	4.37 AC 3.24 5.96 AC. 4.69				
26B	8912 63 8870 ALBEMARLE FARMS	WILLIAM G. JAMES	470	504	TRACT 2	11-18	27.51 28.41 28.46 AC.	JAMES, DERRICK W.	10-E0-12 FOR 2011		
26C	8912 62 4904 ALBEMARLE FARMS	ERNEST M. JAMES TEST TRUST	470	496	TRACT 1	11-18	22.19 18.87 33.19 AC.				
26D	8912 54 9351 ALBEMARLE FARMS	REUBEN EARL JAMES	470	500	TRACT 4	11-18	36.78 37.48 AC.				
27	SEE BELOW 8912(02) 68 6686 CHARLOTTE G. FEARING	SWINDELL + RUTH LOWERY	135 298	118 129		22-14	115.74 119.0 AC.	Lowrey, S.L. & Ruth S.	513-563 1-16-91	LOWERY, S.L. & RUTH S. HEIRS	513-563 FOR '97
28	8912 44 015D I.L. + FATSIE OVERMAN	C. E. OVERMAN HEIRS	90	433			84.0 AC.	W.J. OVERMAN, JR. et al	425-175 12-29-79	OVERMAN, VIRGINIA N. W. J. JR. &	782-642 11-4-03
29	? 8912 02 55 3574 WB-T I.L. OVERMAN	GEORGE REID OVERMAN	WB WB 4	319-320 336		90-434	92.29 93.09 4.5 AC	OVERMAN, JUNE B.	01-E-15 FOR 2009'	KATHERINE O. GUIDRY & CYNTHIA O. WMS CAMPBELL	18-E-258 FOR 2020'
29A	? 8912 02 65 0447	GEORGE REID + JUNE OVERMAN	392	186			2.19 AC LOT	OVERMAN, JUNE B.	01-E-15 FOR 2009'	NATALIE J. PEEL, JOHN A. SR. &	1241-594 11-24-15
26 E	8912 02 85 3499 Lane, Dallas James	Pasquotank Co	499	513			1.27				
26 F	8912 73 1281 James, Vernon S	Pasquotank Co	8-19-89 500	266	1006-3	500-267	1.00				
26 G	8-28-91 James, Vernon S	Pasquotank Co	519	587		16-6	LOT				
26 H	891202753123 James, Vernon S	Pasquotank Co	519	587		16-6	LOT				
26 I	1233-843 of Christ James, Ernest M Test Trust	Trustees of Towne S Church	543	57			6.0 AC				
26 J	From 91-26A 8912 02 85 0271 LANE, DALLAS JAMES	JAMES, SHIRLEY H. & VERNON G. III	594	543		594-544	57 AC	JAMES, VERNON G. III	EST. 7-16-03-E-186 594-543 FOR 2006'		
27A	From Foundry 891-20 8912 025673 Lowrey, S.L. & RUTH S. HEIRS James, Ernest M. Test Trus.	CONAWAY, THOMAS SCOTT Trustees of Towne South Church of Christ	5-13-97 609 5-12-13 1484	491 575		609-493	1.0 AC 9.0 ac	THORNTON, BRENT & NANCY	933-533 9-8-06	LYNAM, JESSICA P. & DANIEL H. &	910-85 5-15-17

PASQUOTANK COUNTY RURAL OWNERSHIP

MAP No. _____

LOT	GRANTEE	D. B. & P.	GRANTEE	D. B. & P.	GRANTEE	D. B. & P.	GRANTEE	D. B. & P.	GRANTEE	D. B. & P.
		DATE		DATE		DATE		DATE		DATE
26	VERNON GRANT James III LANE, DALLAS J. &	02-E-239 For 2003'								
27	HARRELL, GEORGE R. & CAROLYN S. 6114-658 GRAY, CHARLES R. & FAYE H.	607-604 4-4-97	HARRELL, CHARLES R. & FAYE H. LF EST. GRAY, CHARLES R. & FAYE H. &	607-604 8-14-01	1156-376 GRAY, CHARLES R. & FAYE H.	1158-379 11-29-12	G6 FARMS LLC	6300-390 12-29-17		
27A	LYNAM, SEAN D.	1094-420 9-30-10	LYNAM, SEAN D. & LINDSEY H.	1156-308 11-5-12	DAVIS, CHANEN S.	1279-742 4-18-17	Lauren A. Drennon Phthisic, Samuel R J	1343-522 8-13-19	Sutton, DeMar N. & Laskasia L.	1495-928 09-22-23

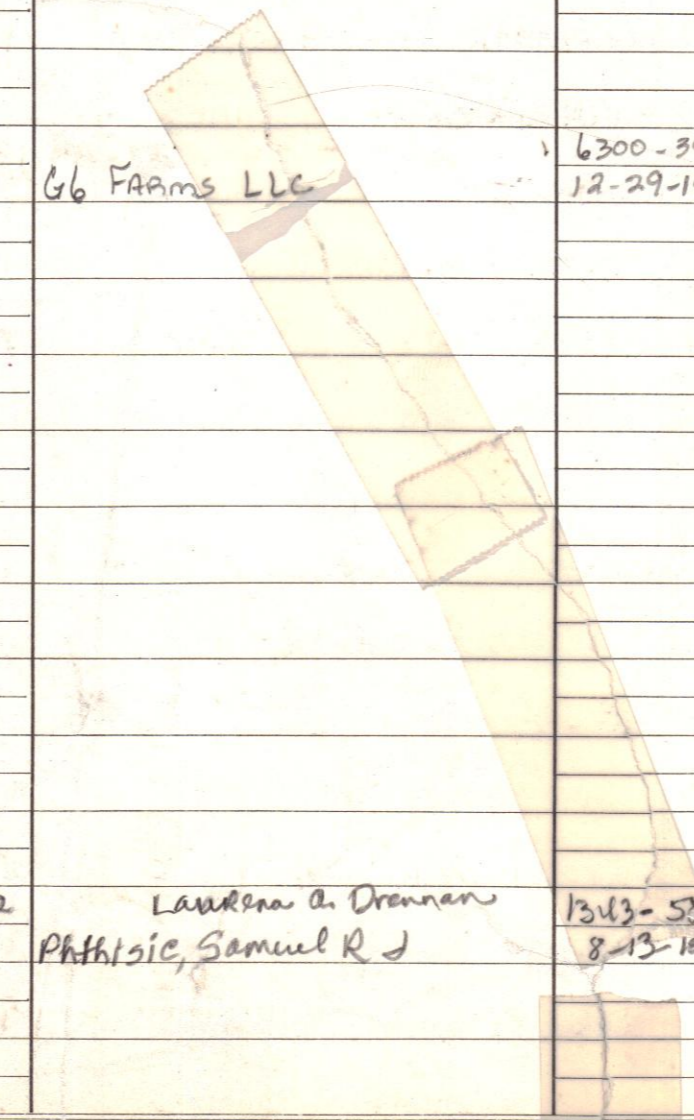

PASQUOTANK COUNTY RURAL OWNERSHIP

TOWNSHIP Nixonton

RURAL MAP No. P-91

PROPERTY NO.	GRANTOR RECORDED OWNER	GRANTEE RECORDED OWNER (BY DEED)	DEED OR WILL BOOK NO.	PAGE NO.	LEGAL LOT NO.	LEGAL PLAT NO.	LOT SIZE OR ACREAGE	GRANTEE	D. B. & P.	GRANTEE	D. B. & P.
									DATE		DATE
30	8912(02) 66 0352 Elizabeth Stevenson	Thomas Edward Stevenson	331	136		43-594 44-46	35 AC	331-136 STEVENSON, RACHEL MARIE CARTER	97-E-214 FOR 98'	331-136 TURNER, LINDA CAROL STEVENSON	97-E-214 FOR 2001
31	SEABLOW 8912(02) 67 1167 Nat: MARGARET DAVIS	Hythe A. Reid & Linnia	329	506		329-508	67.00 68.88 -70.87 AC	Reid, Hythe A	329-506 FOR 992'	REID, PATRICIA PIERSON LIFE EST	1034-35 10-10-08 477-613
32	8912(02) 77 5074 Nat: MARGARET DAVIS	Essie M. & Colos B. Creef Heirs	333	225	3	329-508	134'x172'x162'x167'	GEORGE C. & MILDRED WILLIAMSON	467-239 7-31-86	GEORGE C. & MILDRED WILLIAMSON	6-10-87
33	8912(02) 77 5237 Nat: MARGARET DAVIS	Ernest Jr. & Jillian T. Phillips	360 332	168 393		594-633 329-508	1 AC 2 AC	CAROLYN & DELBERT P. CREEF	370-443 4-20-76	THOMAS G. & KAREN PALMER	459-132 9-26-85
34	8912(02) 77 7404 BILLY P. & ANNETTE HARDELL	PASQUOTANK COUNTY	1-11-85 453	520			TRIANGULAR LOT				
35	From 8914? 8912 02 88 6474 PEDRO & MARLENE HOLLEY	SUNBURY PARK CHILD CARE SER. LTD	632-563 IDA ACRES 5-14-98 629	324	1	12-12	1.35 X 190	HOLLEY, PEDRO & WILLIAMS OLLIE MARLENE	669-709 5-24-00	J.B. CONSTRUCTION & GROUP INC	851-473 4-20-05
36	8912 02 88 1506 ?	ANDREA R. WILLIAMS	1-5-87 472	162	2	"	135 X 190 AV	Speller, NASHING K. & TRAVIS	1420-151 08-16-21		
37	8912 02 88 2428 ?"	SUNBURY PARK CHILD CARE SER. LTD	632-563 5-14-98 629	324	3	"	F97 X 260 AV	HOLLEY, PEDRO & WILLIAMS OLLIE MARLENE	669-709 5-24-00	J.B. CONST. & GROUP INC	851-473 4-20-05
38	8912 02 88 3426 ?"	" " " " " "	632-563	"	4	"	94 X 253 AV	" " " "		" " " "	851-473 4-20-05
39	8912 02 88 4434 ?"	" " " " " "	632-563	"	5	42-17	128 X 243 AV	" " " "		" " " "	851-473 4-20-05
40	8912 02 88 6400 ?"	OLIVER C. HOLLEY JR. & CAROLYN	6-16-87 476	707	6	"	128 X 226 AV	HOLLEY, PEDRO & OLLIE MARLENE	851-471 4-20-05	J.B. CONST. & GROUP INC	851-473 4-20-05
41	8912 02 88 7328 ?"	SUNBURY PARK CHILD CARE SER. LTD	632-563 629	324	7	"	115' X 214 AV	HOLLEY, PEDRO & WILLIAMS OLLIE MARLENE	669-709 5-24-00	J.B. CONST. & GROUP INC	851-473 4-20-05
31A	8912 02 77 7404 Reid, Hythe A	Pasquotank Co	8-17-89 499	400		Survey 499-401	Lot				
31B	8912 02 67 02 86 Reid, Hythe A	EC Rotary Club Foundation	1-7-91 513	270		15-28	Lot	Pasquotank County	513-274 1-14-91		
31C	8912 02 57 08 50 Reid, Hythe A	EC Rotary Club Foundation	1-7-91 513	270		15-28	Lot	Pasquotank County	513-274 1-14-91		
31D	8912 41 60 21 Reid, Hythe A	EC Rotary Club Foundation	1-7-91 513	270		15-28	Lot	Pasquotank County	513-274 1-14-91		
39A	From 891-39 For 2009 891-473 J.B. CONST. & GROUP INC	ABBY GROUP INC	3-15-07 961	324		42-17					
33A	From 891-33 For 2001 8912 02 77 6412 Landrum, Elise A. Watts					65-22	1.0 AC				

PASQUOTANK COUNTY RURAL OWNERSHIP

MAP No. _____

LOT	GRANTEE	D. B. & P. DATE	GRANTEE	D. B. & P. DATE	GRANTEE	D. B. & P. DATE	GRANTEE	D. B. & P. DATE	GRANTEE	D. B. & P. DATE
30										
31	MERCER, William J. - etal	1258-151 7-1-16								
32										
33	Beverly A Vozzella, James R's	516-396 7-15-93	LYNAM, DANIEL H. & JESSICA	594-631 6-26-96	Landrum, ELISE A. watts	1290-104 8-28-17				
35	JOYNER, PATRICIA A.	910-737 4-20-06								
37	CAROLYN W. RICE, STEPHEN ANDREW E	905-39 3-16-06								
38	ABBY GROUP INC	907-373 3-30-06								
39	ABBY GROUP INC	907-373 3-30-06								
40	EDWARDS, CHARLES R.	904-488 3-14-06	VETERANS AFFAIRS	1077-676 3-8-10	WHITE, KATIE MARIE	1086-88 6-11-10	COWELL, CLARENCE M	1234-591 8-18-15	LOVELL, Payton A. & Breana	1490-405 11-03-22
41	WILLIAMS, MARGARET M.	907-572 3-31-06	FEDERAL HOME LOAN MORTGAGE CORP	1058-500 7-1-09	OWENS, James H.	1067-859 10-27-09				

PASQUOTANK COUNTY RURAL OWNERSHIP

TOWNSHIP NIXONTON

RURAL MAP No. P91

TEMPORARY PARCEL NO.	GRANTOR RECORDED OWNER	GRANTEE RECORDED OWNER (BY DEED)	DEED OR WILL BOOK NO.	PAGE NO.	LEGAL LOT NO.	LEGAL PLAT NO.	LOT SIZE OR ACREAGE	GRANTEE	D. B. & P.	GRANTEE	D. B. & P.
									DATE		DATE
42	8912 02 88 8335 PEDRO & MARLENE HOLLEY	632-563 SUNBURY PARK CHILD CARE SERV. LTD	5-14-98 629	324	8	12-12	F122 X 195AV	WILLIAMS HOLLEY, PEDRO & OLLIE MARLENE	469-709 5-24-00	S.B. CONST. & GROUP INC	851-473 4-20-05
43	8912 02 88 9374 " "	SHARP, TED A.	1-17-89 493	9	9	"	F110 X 171AV	Holley, Pedro & Ollie Marlene	496-344 5-16-89	SUNBURY PARK CHILD CARE SERV. LTD	629-324 5-14-98
44	8912 02 98 0572 " "	Robinson, Clara M.	10-11-94 568	132	10	"	F105 X 284AV	S.B. CONSTRUCTION + GROUP INC	1002-276 12-21-07	ABBY GROUP INC	1033-425 10-3-08
45	8912 02 88 9657 " "	632-563 SUNBURY PARK CHILD CARE SERV. LTD	5-14-98 629	324	11	"	F114 X 199AV	WILLIAMS HOLLEY, PEDRO & OLLIE MARLENE	469-709 5-24-00	S.B. CONST. & GROUP INC	851-473 4-20-05
46	8912 02 88 9623 " "	" " " " " "	5-14-98 " "	"	12	"	123 X 202AV	" " " "	" "	S.B. CONST. & GROUP INC	851-473 4-20-05
47	8912 02 88 7617 " "	" " " " " "	5-14-98 " "	"	13	"	118 X 210AV	" " " "	" "	S.B. CONST. & GROUP INC	851-473 4-20-05
48	8912 02 88 5790 " "	" " " " " "	5-14-98 " "	"	14	"	114 X 219AV	" " " "	" "	S.B. CONST. & GROUP INC	851-473 4-20-05
49	8912 02 88 4793 " "	Swimmer, Mark E	10-2-97 533	560	15	"	110 X 227AV	WILLIAMS HOLLEY, PEDRO & OLLIE MARLENE	673-319 8-3-00	S.B. CONST. & GROUP INC	851-473 4-20-05
50	8912 02 88 3787 " "	632-563 SUNBURY PARK CHILD CARE SERV. INC	5-14-98 629	324	16	"	101 X 235AV	WILLIAMS HOLLEY, PEDRO & OLLIE MARLENE	469-709 5-24-00	S.B. CONST. & GROUP INC	851-473 4-20-05
51	8912 02 88 2789 " "	" " " " " "	5-14-98 " "	"	17	"	100 X 246AV	" " " "	" "	S.B. CONSTRUCTION & GROUP INC	851-473 4-20-05
52	8912 02 88 1737 " "	ANDREW H. & RUBENIA WILLIAMS	1-5-87 472	160	18A	25-37	11,366 SF 132 X 190	WILLIAMS, RUBENIA S.	472-160 FOR 2011	Seannette Faye brothers, David Lee	1419-771 08-18-31
53	8912 02 88 1760 " " 1899	632-563 SUNBURY PARK CHILD CARE SERV. LTD	5-14-98 629	324	19B	"	14,622 SF F134 X 190	ELIZABETH CITY NEIGHBORHOOD COOP	670-44 5-31-00	Kee, JETHRO SR & SHARON	682-794 6-22-01
(FROM P92-13) 54	8912 61 2584 908 207 HARVEY EUGENE MEADS & SHIRLEY						8,753 SF 4.95 85,7643	Parcel deleted - subdiv. into TWIN TREE Subdiv. FOR 2008	Parcel deleted - subdiv. into parcels P91-167 thru P91-171		
54A	Meads, Eugene & Shirley	Meads, Vance A & Deloris O	2-6-91 519	126			Lot (334x225)	Deleted (see P92-365 & 366)			
(From 91-6A-7) 55	Fletcher, Pat & Hurdie	Hurdie & Wells Construction	12-10-93 557	282			Lot	See P91-71			
52A	WILLIAMS, Andrew H. & RUBENIA				18B	25-37	11,909 sq ft.				
53A	8912 02 88 1902 SUNBURY PARK CHILD CARE SERVICES LTD	SAMANTHA M. AMES, SHAWN L. SR &	5-2-00 668	643	19A	668-644	10,428 SF	WALTERS, STUART A.	923-137 7-3-06	Elstoad + Child W + Lindsay	923-137 7-3-06
54B	MEADS, HARVEY & SHIRLEY	TRINITY BAPTIST FELLOWSHIP	4-26-01 688	199		28-21	7.0 AC	WORSHIP VENTURES OF HARRISBURG LLC	849-844 4-11-05	Accumulated Resources of Kindred Spirits	849-844 4-11-05

PASQUOTANK COUNTY RURAL OWNERSHIP

MAP No. _____

LOT	GRANTEE	D. B. & P.	GRANTEE	D. B. & P.	GRANTEE	D. B. & P.	GRANTEE	D. B. & P.
		DATE		DATE		DATE		DATE
42	ABBY GROUP INC	907-373 3-30-06						
43	HOLLEY, PEDRO & WILLIAMS OLIVE MARLENE	669-709 5-24-00	JB CONST. & GROUP INC	851-473 4-20-05	SQUYRES, SHAUN IAN JR	905-517 3-20-06	& TIFFANY M. SQUYRES, SHAUN IAN JR	1173-156 5-7-13
45	EASON, WILLIAM ISSAC	898-812 2-7-06						
46	WILSON, Kenneth & COULOMBE BETH C.	924-19 7-10-06						
47	WIGGINS, SHEILA RENEE	898-532 2-6-06	Federal NATIONAL MORTGAGE ASSOC.	1018-157 5-7-08	KING, BRETT & ANGIE E. CHAPPELL	1032-613 9-26-08		
48	SHOEMAKER, MARK & DAWN	906-382 3-24-06						
49	ABBY GROUP INC	907-373 3-30-06						
50	GORDON B. OLIVER PARTAIN, Cindy W. & GORDON	897-813 2-1-06	OLIVER, Gordon B.	995-717 10-30-07	OLIVER, Gordon B.	1076-486 2-22-10	InGRAM, Joyce A.	1233-590 8-4-15
51	BARBARA JO KIRBY KIRBY, JOHN FREEMAN &	907-824 4-3-06	McCoy, TASHI P. LYNWOOD G. SR &	1084-251 5-21-10	MULLEN, Tony & MARIA GIBBS	1122-669 10-14-11		
53	HOUSING & URBAN Development	834-346 12-21-04	WALTERS, STUART A.	850-291 4-13-05	Ronald L. Pindleton Sr PRAYERS, Jennifer L &	981-166 7-20-07		
53A	McCLURE, DENNIS S.	1013-100 3-31-08	HOUSING & URBAN Dev. OF FC	1187-596 10-10-13	TOP REAL ESTATE INVEST	1196-439 2-25-14		
54B	RELIANCE CAROLINA PROPERTIES LLC	1090-560 8-11-10	TRINITY BAPTIST FELLOWSHIP	1126-17 1-9-12	Freedom Baptist Ministries	1487-530 06/14/23		

PASQUOTANK COUNTY RURAL OWNERSHIP

TOWNSHIP *Nixonton Inside*

RURAL MAP No. *P91*

TEMPORARY PARCEL NO.	GRANTOR RECORDED OWNER	GRANTEE RECORDED OWNER (BY DEED)	DEED OR WILL BOOK NO.	PAGE NO.	LEGAL LOT NO.	LEGAL PLAT NO.	LOT SIZE OR ACREAGE	GRANTEE	D. B. & P. DATE	GRANTEE	D. B. & P. DATE
55	891202 76 8762 Fletcher Perry, Hurdle	HURDLE & WEBB CONSTRUCTION CO INC	12-22-95 586	310	1	18-41,42	LOT	Barr, Jimmy D & Lori J	763-940		
56	891202 76 7772	HURDLE & WEBB CONST. CO INC	12-22-95 586	310	2	"	"	TRANSFER ERROR corrected - ZAHAND, ANITA 12/4/03	06-25-03 684-49	Hurdle, Nathan S.	1097-386 11-4-10 →
57	891202 76 6772	HURDLE & WEBB CONST CO	9-30-94 567	621	3	"	"	Barbara A. KISHBAUGH, JOHN M. &	589-80 3-8-96	1257-660 KISHBAUGH, Barbara A. LF EST	1219-876 2-4-15 →
58	891202 76 7831	HURDLE & WEBB CONST CO INC	12-22-95 586	310	4	"	"	Hurdle, Nathan S.	1097-386 11-4-10	Hurdle, Nathan S. & Nellie F.	1184-152 8-30-13 →
59	891202 76 7849	" " " " "	12-22-95 586	310	5	"	"	Powers, TAMELA T.	963-613 3-30-07		
60	891202 76 7958	" " " " "	"	"	6	"	"	VICTORIA R. GRIMM, CHARLES M. &	927-781 8-2-06	Grimm, Charles M.	927-781 For 2022 →
61	891202 77 7076	" " " " "	"	"	7	"	"	TRAN, DAVED & THY A.D. AN	720-22 5-21-02	TRAN, DAVED	1007-356 2-12-08
62	891202 77 7195	" " " " "	"	"	8	"	"	Hurdle, Nathan S.	1097-386 11-4-10	NELLIE F. Hurdle, Nathan S. &	1184-152 8-30-13 →
63	891202 77 8204	" " " " "	"	"	9	"	"	Sims, Jean M.	724-666 7-12-02		
64	891202 77 9241	" " " " "	"	"	10	"	"	Walker, Charles M.	626-303 3-31-98	DAVIS, LAUREN E.	1312-887 6-14-18
65	891202 87 0230	" " " " "	"	"	11	"	"	WILMA H. WALKER, WILBER J. &	763-228 6-19-03	SUSAN W. FENWICK WALKER, CHARLES M. &	09-E-284 For 2013 922-929
66	891202 87 1129	" " " " "	"	"	12	"	"	WALKER, WILMA H. & WILBER	736-694 11-7-02	WALKER, SUSAN D.	6-30-06
67	891202 87 0097	" " " " "	"	"	13	"	"	WRIGHT, CORINNIA F.	646-575 3-8-99	BACCUS, IRVING	795-389 3-8-04 →
68	891202 77 9089	" " " " "	"	"	14	"	"	ONLEY, STEVEN & DENISE L.	812-941 7-16-04		
69	891202 77 9003	" " " " "	"	"	15	"	"	ONLEY, STEVEN R. & DENISE L.	758-823 5-16-03		
70	891202 76 8898	HURDLE & WEBB CONST. CO INC	12-22-95 586	310	16	"	"	EVANS, DEBRA M.	588-286 2-16-96	HURDLE & WEBB CONSTRUCTION CO INC	603-180 12-20-96 →
546	8912 511729 meads, H. EUGENE & Shirley	ALDEMARE HOME BUILDERS INC	1-15-08 1004	951			1.488 AC	Marlene Wilkins, James Darrell	1482-527 041423		

PASQUOTANK COUNTY RURAL OWNERSHIP

MAP No. 991

LOT	GRANTEE	D. B. & P. DATE	GRANTEE	D. B. & P. DATE	GRANTEE	D. B. & P. DATE	GRANTEE	D. B. & P. DATE
56	NELLIE F. HURDLE, NATHAN S. & LORRAINE S.	1184-152 8-30-13	Barr, Jimmy Lee & Lori Jill	1375-948 8-14-2000				
57	SCHWENZFEIER, JOHN A. & Whitehurst, Joseph Patrick ETAL	1280-534 4-27-17	Simmons, Paris M. & Grace Denise S.	1371-220 06-30-2020				
58	Whitehurst, Joseph Tildon, Jr.	1402-752 03-30-21	Rothrock, Kenneth R. &	1467-858 10-07-22				
60	Gravesande, Sean & Rosalba	1470-94 10-31-22						
62	Whitehurst, Joseph Patrick ETAL Whitehurst, Joseph Tildon, Jr.	1402-752 03-30-21	Gerber, Samuel E.	1458-199 06-27-22	Barras, Janet Yvette John Francis &	1478-595 08-27-23		
67	VETERANS AFFAIRS	1222-56 3-9-15	Ogwen Loan Servicing LLC	1229-805 6-16-15	VETERANS AFFAIRS	1229-807 6-16-15	MOARSETTE, LUCYEN O.	1235-259 8-27-15
70	(was listed under name of wife) ATKINSON, ROBERT L. & TERESA	604-225 1-13-97	Edwards, Amy W. Randall Wayne &	806-725 6-1-04	EDWARDS, Amy WHITEHURST	1096-824 10-29-10		1244-741 1-15-16 KATELYN M. GAGGATT, CAMERON T. &

PASQUOTANK COUNTY RURAL OWNERSHIP

TOWNSHIP Nixonton Inside

RURAL MAP No. P91

TEMPORARY PARCEL NO.	GRANTOR RECORDED OWNER	GRANTEE RECORDED OWNER (BY DEED)	DEED OR WILL BOOK NO.	PAGE NO.	LEGAL LOT NO.	LEGAL PLAT NO.	LOT SIZE OR ACREAGE	GRANTEE	D. B. & P.	GRANTEE	D. B. & P.
									DATE		DATE
71	891202861922 Fletcher Perry + Hurdle	Hurdle + Webb Construction	12-10-93 554	282	17	18-41,42	LOT	CHANCE, CONRAD L. + JERRY	566-584 9-7-94	HARRIS, Margaret C.	862-929 7-1-05
72	891202862915 " " "	HURDLE & WEBB CONST CO INC	12-22-95 586	310	18	"	"	NEHEMIAH II INC	718-405 4-30-02	Möhler, Aaron B & Bethany J	776-873 07-17-03
73	891202872061 " " "	" " " " "	"	"	19	"	"	NEHEMIAH II INC	718-405 4-30-02	PLATT, SEANNETTE A.	763-497 6-23-03
74	891202872080 " " "	" " " " "	"	"	20	"	"	EAKINS, GREGORY & ROSE H.	596-168 7-24-96	WELLS FARGO BANK, N.A.	1202-524 5-27-14
75	891202872196 " " "	" " " " "	"	"	21	"	"	HURDLE, NATHAN S.	630-295 6-3-98	FOREMAN, Roy ANTHONY & ROBIN B.	657-446 8-31-99
76	891202874142 " " "	" " " " "	"	"	22	"	"	HOWARD, RAMONA R. & DARRON E DEVON	617-792 10-24-97	HOWARD, RAMONA RENEE	1066-66 10-1-09
77	891202875194 " " "	" " " " "	12-22-95 586	310	23	"	"	GILANS, DARRON R + Kimberly A	873-317 9-1-05	Dorothy & HENSHAW, KENNETH P +	982-758 7-31-07
78	891202876243 " " "	SEYMORE, ROY RUDOLPH	8-23-95 580	738	24	"	"	HURDLE, NATHAN S.	1066-362 10-6-09	HURDLE, NATHAN S. & NELLIE F.	1184-152 8-30-13
79	891202875390 " " "	HURDLE & WEBB CONST CO INC	12-22-95 586	310	25	"	"	Baker, Cheryl O.	990-735 9-21-07	Fed NATL MORTGAGE ASSOC.	1184-427 9-5-13
80	891202874372 " " "	" " " " "	"	"	26	"	"	Godfrey, CRYSTAL OVERTON	638-477 10-16-98	Fed Home Loan Mortgage Corp	133-641 3-5-12
81	891202873383 " " "	" " " " "	"	"	27	"	"	Wanda EURE SPENCE, JERMAINE LEROY & JANIE W.	827-862 10-29-04	THELMA L. D'NEAL, CARLTON M. &	964-246 4-5-07
82	891202872395 " " "	" " " " "	"	"	28	"	"	COFIELD, BERNARD J. &	598-424 9-9-96		
83	891202872307 " " "	" " " " "	"	"	29	"	"	EGLISTON, DELORIS J.	698-520 8-31-01		
84	891202871308 " " "	HURDLE & WEBB CONST CO INC	12-22-95 586	310	30	"	"	DERRECK H. EGLISTON, DELORIS J. &	733-415 10-11-02		
85	891202870412 " " "	MORRIS, MICHAEL SR	12-30-94 571	529	31	"	"				
86	891202779421 " " "	HURDLE & WEBB CONST CO INC	12-22-95 586	310	32	"	"	PARCEL deleted Dec 2002 split between LOTS 31 & 33			

PASQUOTANK COUNTY RURAL OWNERSHIP

MAP No. _____

LOT	GRANTEE	D. B. & P. DATE	GRANTEE	D. B. & P. DATE	GRANTEE	D. B. & P. DATE	GRANTEE	D. B. & P. DATE
72	MOHLER, AARON B.	1165-304 2-20-13						
73	LOANT THAI, Tien My - Nguyen, Thu	863-73 7-1-05	THAI, TIEN my	1039-196 12-30-08	CYNTHIA R. Kinney THALman, NORMA L. E.	1295-273 10-30-17		
74	LEARY, WILLIAM E. & TERESA	1223-554 3-30-15						
76	COWELL, KELLY	1070-126 11-23-09						
77	FIRST SOUTH BANK NICOLE MARIE HEBERT, BENJAMIN PAUL E.	1154-331 10-17-12		1177-609 6-24-13	VETERANS AFFAIRS	1259-852 7-27-16	THOMAS, KATHRYN L.	1268-710 11-14-16
78	TASHEGA J. STALLINGS, DOMINIC D. E.	1308-935 4-25-18	Billups, Jeffrey A. II	1465-89 09-08-22				
79	JOYCE M. CLARK LILES, JONATHAN D. E.	1210-621 9-17-14	ALYSSA S. Stanley, Joseph L.	1412-621 06-11-21	Monet Basnight Earle, William Christian	1490-806 07-24-23		
80	BERRY, PATSY C. & Tony L.	1160-277 12-19-12						

PASQUOTANK COUNTY RURAL OWNERSHIP

TOWNSHIP Nixonton Inside

RURAL MAP No. 91

TEMPORARY PARCEL NO.	GRANTOR RECORDED OWNER	GRANTEE RECORDED OWNER (BY DEED)	DEED OR WILL BOOK NO.	PAGE NO.	LEGAL LOT NO.	LEGAL PLAT NO.	LOT SIZE OR ACREAGE	GRANTEE	D. B. & P.	GRANTEE	D. B. & P.
									DATE		DATE
87	891202778432 Fletcher, Perry, Hurdle	HURDLE & WEBB CONST CO INC	12-22-95 586	310	33	18-41,42	LOT	HURDLE, NATHAN S.	637-297 9-24-98	697-651 FIELD, EARLE W. JR.	677-702 10-27-00
88	891202865764	" " " " "	"	"	34	"	"	COX, GEORGE HERMAN & SHELLEY LANE	660-9 10-26-99	PETERS, JOSHUA M. & JESSICA R.	878-583 7-3-05
89	891202866764	" " " " "	"	"	35	"	"	HURDLE, NATHAN S.	1097-386 11-4-10	HURDLE, NATHAN S. & NELLIE F.	1184-152 8-30-13
90	891202867764	" " " " "	"	"	36	"	"	ZAHAND, ANITA	684-49 3-1-01	SEALS, KEVIN J. & ANGELA R.	866-376 7-25-05
91	891202867865	" " " " "	"	"	37	"	"	MEKOSH, JOHN & DOROTHEA C.	649-468 4-23-99	BRENDA SUE NORRIS, BARRY WADE &	673-916 8-15-00
92	891202866865	HURDLE & WEBB CONST CO. INC	12-22-95 586	310	38	"	"	Brown, Sharon & Kelvin	786-5 12-11-03		
93	891202865865	HURDLE & WEBB CONSTRUCTION CO. INC	4-12-95 575	238	39	"	"	WARD, JERRY C. & SHEILA B.	590-421 4-3-96	WARD, SHEILA B.	603-733 1-2-97
94	891202863984	" " " " "	12-22-95 586	310	40	"	"	BROWN, KELLI	615-36 8-29-97	615-36 ROBESON, KELLI T.	MAARRIED FOR 99
95	891202874033	" " " " "	"	"	41	"	"	HURDLE, NATHAN S.	1097-386 11-4-10	HURDLE, NATHAN S. & NELLIE F.	1184-152 8-30-13
96	891202875064	" " " " "	"	"	42	"	"	NIXON, BILLY R. & JECKIE B.	594-563 6-26-96	BERNADINE T. SPENCE, TONY A. &	676-345 9-29-00
97	891202876064	" " " " "	"	"	43	"	"	ANTIONETTE M. TEDONE, JAMES J. &	649-457 4-23-99	ROBBINS, DANA	1031-563 9-12-08
98	891202877065	" " " " "	"	"	44	"	"	BRAYMILLER, BRIAN D. & LYNN R.	649-452 4-23-99		
99	891202877137	" " " " "	"	"	45	"	"	OVERTON, Wm R, JR & Jewel	882-339 10-24-05		
100	891202877286	HURDLE, NATHAN S.	11-17-95 584	740	46	"	"	AUTISM SOCIETY OF N.C. INC	621-286 12-29-97	North Carolina Inc Autism Foundation of	950-515 12-28-06
101	891202878296	HURDLE & WEBB CONST. CO INC	12-22-95 586	310	47	"	"	Ly, THAI P.	1020-546 5-29-08		
102	891202879251	" " " " "	12-22-95	"	48	"	"	GORE, Robert & Demetrius	865-262 7-19-05	UNITED STATES OF AMERICA	1144-15 6-29-12

PASQUOTANK COUNTY RURAL OWNERSHIP

TOWNSHIP Nixonton Inside

RURAL MAP No. 991

TEMPORARY PARCEL NO.	GRANTOR RECORDED OWNER	GRANTEE RECORDED OWNER (BY DEED)	DEED OR WILL BOOK NO.	PAGE NO.	LEGAL LOT NO.	LEGAL PLAT NO.	LOT SIZE OR ACREAGE	GRANTEE	D. B. & P.	GRANTEE	D. B. & P.
									DATE		DATE
103	891202879049 Fletcher, Perry, Hurdle	Hurdle & Webb Const. Co Inc	12-22-95 586	310	49	18.41 42	LOT	COLE, HENDRICK TOLOSO - ETAL	613-793 8-6-97	wendy J. CALLAHAN, GERALD E. &	932-880 9-5-06
104	891202869949	" " " " "	"	"	50	"	"	RAPER, LOUISE R.	652-712 6-15-99	ROBIN L. SCHAEFER, DOUGLAS F. &	1185-514 9-17-13
105	891202869940	MOORE, GEORGE LEE, JR & DEIDRE A.	3-31-95 574	849	51	"	"	"	"	"	"
106	891202869841	Hurdle & Webb Const. Co Inc	12-22-95 586	310	52	"	"	SEWALL, Samuel B & Phyllis J.	636-541 9-14-98	WHITE, DANIEL J.	1075-733 2-12-10
107	891202869743	Hurdle & Webb Const Co Inc	12-22-95 586	310	53	"	"	HURDLE, NATHAN S.	621-401 12-31-97	D. BARBARA STEELY, James ODIE &	632-23 6-29-98
108	8912 619172 MEADS, H. EUGENE & SHIRLEY	Sawyer & Assoc. Realty & Const. Co	8-2-05 868	3	1	38-29-32	48,744 SF	JAVREK, MICHAEL & Barbara E.	976-357 6-20-07	"	"
109	8912 710242	" " " "	"	"	2	"	44,686 SF	meads Home Builders Inc	1255-498 6-2-16	MASOKA, BILLIE & wayne M. sarah G.	1290-42 8-28-17
110	8912 812323	" " " "	"	"	3	"	43,560 SF	meads Home Builders Inc	1255-498 6-2-16	CARTER, ANTWAIN L. &	1286-746 7-11-17
111	8912 711474	" " " "	"	"	4	"	43,560 SF	" " " "	" " " "	CHARLOTTE Burgess Mitchell KOCH, JAMIE MITCHELL &	1283-700 6-2-17
112	8912 712535	" " " "	"	"	5	"	43,560 SF	" " " "	" " " "	Donna GOETZ BLASKO, Amanda &	1280-512 4-27-17
113	8912 713677	" " " "	"	"	6	"	43,560 SF	" " " "	" " " "	Dwens, Terry W. & Marilyn B.	1276-869 3-15-17
114	8912 713892	" " " "	"	"	7	"	63,783 SF	THORNTON, BRENT ROBERT	1210-42 9-5-14	Heath, Dennis T. & Neda L.	1319-843 10-25-19
115	8912 712988	" " " "	"	"	8	"	46,960 SF	meads Home Builders Inc	1299-55 12-14-17	CARTWRIGHT, HERBERT L.	1308-824 4-25-18
116	8912 710972	" " " "	"	"	9	"	43,560 SF	meads Home Builders Inc	1299-55 12-14-17	WRIGHT, Thomas ERIC & LISA M.	1329-746 2-22-19
117	8912 629051	" " " "	"	"	10	"	43,560 SF	meads Home Builders Inc	1255-498 6-2-16	Barbara Ann JONES, PAUL Edward &	1279-807 4-19-17
118	8912 628037	" " " "	"	"	11	"	43,560 SF	" " " "	" " " "	Barbara Ann JONES, PAUL Edward &	1297-82 11-20-17
119	8912 627122 MEADS, H. EUGENE & SHIRLEY	Sawyer & Assoc. Realty & Const. Co.	8-2-05 868	3	12	38-29-32	43,560 SF	" " " "	" " " "	Tina M. NORIEGA BROWN, CARTRELL, R. &	1331-352 3-15-19

" IVY TRACE SUBDIVISION "

PASQUOTANK COUNTY RURAL OWNERSHIP

MAP No. 991

LOT	GRANTEE	D. B. & P. DATE	GRANTEE	D. B. & P. DATE	GRANTEE	D. B. & P. DATE	GRANTEE	D. B. & P. DATE
106	HAGIUS, Lynn K.	1253-427 5-6-16	Howard Robert E. Ritter, Donna J. &	1472-179 11-30-22				
107	Canada, MICHAEL JACQUELINE	1224-868 4-16-15	Darlene Taylor Culpeper, Stacy Lee &	1479-581 03-10-23				
109	Angela M. Welsh LIZZA, MARTIN M. R. DE ↓	1325-721 12-13-18	welsh, Angela M.	1334-922 5-6-19				
111	Majetich, Paul J.	1400-473 03-12-21						
113	1276-869 OWENS, MARYLYN B.	19-E-166 For 2020'						
115	Tri B Construction, Inc.	1398-441 02-22-21	Mazzenga, Jamie & Michael	1444-940 03-11-22				
117	Miles, Kevin G. Miles-Canale, Regina	1410-395 05-26-21						
118	Amberly Lousse GRIFFITH, James Leon &	1307-264 7-5-18	Stokley, Chris	1398-946 02-26-21				

PASQUOTANK COUNTY RURAL OWNERSHIP

TOWNSHIP NIXONTON

RURAL MAP No. P91

TEMPORARY PARCEL NO.	GRANTOR RECORDED OWNER	GRANTEE RECORDED OWNER (BY DEED)	DEED OR WILL BOOK NO.	PAGE NO.	LEGAL LOT NO.	LEGAL PLAT NO.	LOT SIZE OR ACREAGE	GRANTEE	D. B. & P.	GRANTEE	D. B. & P.
									DATE		DATE
120	MEADS, H. EUGENE & SHIRLEY	Sawyer & Assoc. REALTY & CONST. CO	8-2-05 868	3	13	38-29-32	43,560 SF	meads Home Builders INC	1255-498 6-2-16	WIGGINS, DERRICK JERMAINE	1336-660 5-29-19
121	" " " "	" " " "	" "	"	14	"	43,560 SF	" " " "	" "	Allen, Charles M & Kathleen	1342-511 8-1-19
122	" " " "	" " " "	" "	"	15	"	43,560 SF	" " " "	" "	James, Travis Heath & Jessica Marie	1364-318 4-22-2000
123	" " " "	" " " "	" "	"	16	"	43,560 SF	KUNKLER, JAMES A.	1154-563 10-19-12	ERMILE D. JAMES TETTERTON, WILLIAM E. &	1236-814 9-15-15
124	" " " "	" " " "	" "	"	17	"	43,560 SF	PARSONS, CORY L. & GINA S.	1154-443 10-18-12		
125	" " " "	" " " "	" "	"	18	"	43,560 SF	CRUTCHLEY, SALLY W.	1000-82 12-3-07		
126	" " " "	" " " "	" "	"	19	"	49,958 SF	AIDDICK, Terrence W & Shawn	1325-852 12-14-18	Brickhove, Jonathan Paul & Alexandria James	1373-829 07-24-2000
127	" " " "	" " " "	" "	"	20	"	44,693 SF	GENERAL CONTRACTING Support Inc	1222-445 3-16-15	GRAMBY, MICHAEL & ANN	1259-366 7-22-16
128	" " " "	" " " "	" "	"	21	"	46,117 SF	GENERAL CONTRACTING Support Inc	1222-448 3-16-15	PANTAK, MARK JOSEPH	1288-693 8-11-17
129	" " " "	" " " "	" "	"	22	"	47,752 SF	LYNETTE A. MED, DOMINIC S. &	1001-381 12-17-07		
130	" " " "	" " " "	" "	"	23	"	46,874 SF	woody, LEWIS D. & TONI A.	984-347 8-8-07	woody, LEWIS D.	1225-224 4-22-15
131	" " " "	" " " "	" "	"	24	"	45,399 SF	SARAH Cartwright, Grantham E &	928-893 For 2008	CARTWRIGHT, GRANTHAM	1122-745 10-17-11
132	" " " "	" " " "	" "	"	25	"	49,321 SF	CATHERINE A. MCDYER, STEVEN D. &	933-885 9-12-06	Walston Robert D. & Tammy M.	1282-633 10-08-2000
133	" " " "	" " " "	" "	"	26	"	47,463 SF	CHAUNTRISS P. STUCK, DELTON W. &	977-305 6-27-07	Holland, Edward P. & Karen L.	1357-642 2-3-2000
134	" " " "	" " " "	" "	"	27	"	44,090 SF	MARIA M. GARCIA CUNNINGHAM, JOHN C. &	968-797 5-7-07	JESSICA R. moody, CHRISTOPHER E. &	1250-775 4-4-16
135	" " " "	" " " "	" "	"	28	"	43,560 SF	SYLVIA C. BREEDEN, JOHN J. JR &	1192-179 12-13-13		
136	" " " "	" " " "	" "	"	29	"	43,560 SF	1000-135 TARA L. ALEXANDER, JOHNIE E. &	971-761 5-24-07		
137	MEADS H. EUGENE & SHIRLEY	Sawyer & Assoc. REALTY & CONST. CO	8-2-05 868	3	30	38-29-32	43,591 SF	CAPE MICHAEL & KAREN E.	971-497 5-27-07		

TEMPORARY PARCEL NO.	GRANTOR RECORDED OWNER	GRANTEE RECORDED OWNER (BY DEED)	DEED OR WILL BOOK NO.	PAGE NO.	LEGAL LOT NO.	LEGAL PLAT NO.	LOT SIZE OR ACREAGE	GRANTEE	D. B. & P. DATE	GRANTEE	D. B. & P. DATE
138	MEADS, H. EUGENE & SHIRLEY 8912 517355	Sawyer & Assoc. REALTY & CONST CO	8-2-05 868	3	31	38-29-32	43,560 SF	Blow, Catherine Watson, Dean Lay Charles & Romani	1321-5 6-19-2020	Blough Builders, LLC	1504-382 01-25-24
139	" " " " 8912 518246	" " " "	"	"	32	"	43,560 SF	Lagido, Mario M. & Maria T. Shawn	1418-60 07-29-21		
140	" " " " 8912 519147	" " " "	"	"	33	"	43,560 SF	Riddick, Terence W. &	1310-920 5-18-18	Gilbert, Daisy	1325-734 12-14-18
141	" " " " 8912 610048	" " " "	"	"	34	"	43,560 SF	STRATHERN, JANET MANN	986-774 8-23-07		
142	" " " " 8912 601949	" " " "	"	"	35	"	43,560 SF	meads Home Builders Inc	1255-498 6-2-16	ELLESTAD, MERRY L. James G. &	1318-18 8-24-18
143	" " " " 8912 602940	" " " "	"	"	36	"	43,560 SF	" " " "	" "	DESROCHE, Leeland P.	1319-288 9-19-18
144	" " " " 8912 603841	" " " "	"	"	37	"	43,560 SF	" " " "	" "	SR & Vianne FELICIA THIBEAULT, ROBERT JOSEPH	1318-575 8-31-18
145	" " " " 8912 614089	" " " "	"	"	38	"	43,560 SF	" " " "	" "	AYOUBI, FRANCES C. EL-	1296-187 11-9-17
146	" " " " 8912 615250	" " " "	"	"	39	38-29-32	43,560 SF	" " " "	" "	MCNAIR, James & Deborah	1297-752 12-1-17
147	" " " " 8912 616322	" " " "	"	"	40	"	43,813 SF	" " " "	" "	INGRID FUNESVILLAFUERTE, RICHARD &	1300-733 1-9-18
148	" " " " 8912 616493	" " " "	"	"	41	"	43,564 SF	" " " "	" "	HANSEN, MATTHEW ERIC	1298-402 12-8-17
149	" " " " 8912 617523	" " " "	"	"	42	"	44,567 SF	" " " "	" "	ALLEN, Andrew P.	1306-725 3-29-18
150	" " " " 8912 618643	" " " "	"	"	43	"	43,567 SF	B & L Contracting LLC	1250-462 3-30-16	Brunner, Andrew & NATASHA	1290-336 8-30-17
151	" " " " 8912 619705	" " " "	"	"	44	"	44,445 SF	meads Home Builders Inc	1255-498 6-2-16	Siedenburg, Douglas W. & Tonga P.	1359-371 2-25-2020
152	" " " " 8912 615898	" " " "	"	"	45	"	49,385 SF	Williams, Fannie G. Linwood L. SR &	1278-286 3-30-17	ASIKA, ZAHRA R.	1335-179 5-9-19
153	" " " " 8912 615715	" " " "	"	"	46	"	43,560 SF	" " " "	" "	GALKO, Jamison	1302-657 2-2-18
154	" " " " 8912 614644	" " " "	"	"	47	"	43,560 SF	Williams, Fannie G. Linwood L. SR. &	1299-61 12-14-17	Green, Carol Lee & Kelli	1343-51 8-6-19
155	MEADS H. EUGENE & SHIRLEY 8912 613574	Sawyer & Assoc. REALTY & CONST CO.	8-2-05 868	3	48	38-29-32	43,560 SF	Williams, Kim R. PARTOLAN, SALVADOR R. SR &	1074-548 1-27-10	Pitman, Bruce & Desiree	1342-48 07-26-19

PASQUOTANK COUNTY RURAL OWNERSHIP

TOWNSHIP Nixon

RURAL MAP No. P91

TEMPORARY PARCEL NO.	GRANTOR RECORDED OWNER	GRANTEE RECORDED OWNER (BY DEED)	DEED OR WILL BOOK NO.	PAGE NO.	LEGAL LOT NO.	LEGAL PLAT NO.	LOT SIZE OR ACREAGE	GRANTEE	D. B. & P.	GRANTEE	D. B. & P.
									DATE		DATE
156	MEADS, H. EUGENE & SHIRLEY 8912 613332	Sawyer & Assoc. Realty & Const. Co.	8-2-05 868	3	49	38-29-32	47,439 SF	Williams, Fannie G. & Linwood L. SR &	1299-61 12-14-17	Sullivan, Mary Kathryn David 1348-458 01-13-19	1348-458 01-13-19
157	" " " " 8912 611492	" " " "	" "	"	50	"	43,560 SF	" " " "	1299-61 12-14-17	COAPREX, Tony Lynn Michael Jay JR &	1332-31 3-27-19
158	" " " " 8912 519567	" " " "	" "	"	51	"	52,336 SF	Williams, Fannie G. & Linwood L. SR &	1256-688 6-17-16	Leonda M. Williams, Howard O. JR &	1293-156 1-13-17
159	" " " " 8912 610629	" " " "	" "	"	52	"	47,619 SF	Williams, Fannie G. & Linwood L. SR &	1256-688 6-17-16	Sutton, Jonathan Ramon	1310-46 5-8-18
160	" " " " 8912 610891	" " " "	" "	"	53	"	43,560 SF	" " " "	" "	Nixon, Ronald Q. II	1305-927 3-21-18
161	" " " " 8912 611963	" " " "	" "	"	54	"	43,560 SF	" " " "	" "	Hicks, Mondrale & Amelia B.	1294-143 10-16-17
162	" " " " 8912 622054	" " " "	" "	"	55	"	43,560 SF	" " " "	" "	Coley, Tony Lee JR & Kanika	1289-685 8-23-17
163	" " " " 8912 529086	" " " "	" "	"	56	"	43,560 SF	JONES, CHRISTINA L.	936-155 9-26-06		
164	" " " " 8912 528161	" " " "	" "	"	57	"	43,560 SF	OTT, MICHAEL C. & H. SUZANNE	928-30 8-4-06		
165	" " " " 8912 527157	" " " "	" "	"	58	"	43,560 SF	Saunders, Clinton R. & Clair K.	1360-988 11-07-19		
166	MEADS, H. EUGENE & SHIRLEY 8912 518804	Sawyer & Assoc. Realty & Const. Co.	8-2-05 868	3	59	38-29-32	43,560 SF	Smith, Robert David & Ruth Ann	1334-24 4-25-19		
167	MEADS, H. EUGENE & SHIRLEY 8912 521001	ALBEMARLE HOME BUILDERS INC	8-15-07 985	412	1	45-18	.99 AC				
168	" " " " 8912 521244	" " " "	8-15-07	"	2	"	"				
169	" " " " 8912 612584	" " " "	8-15-07	"	3	"	"				
170	" " " " 8912 523725	" " " "	8-15-07	"	4	"	"				
171	MEADS, H. EUGENE & SHIRLEY 8912 524914	" " " "	8-15-07 985	412	5	45-18	.99 AC				
172	LANE, DALLAS JAMES 8912 853219	LANE, CHARLES Thomas SR	5-7-08 1018	160		48-2	1.13 AC				

PASQUOTANK COUNTY RURAL OWNERSHIP

 TOWNSHIP NIXONTON Inside

 RURAL MAP No. P91

TEMPORARY PARCEL NO.	GRANTOR RECORDED OWNER	GRANTEE RECORDED OWNER (BY DEED)	DEED OR WILL BOOK NO.	PAGE NO.	LEGAL LOT NO.	LEGAL PLAT NO.	LOT SIZE OR ACREAGE	GRANTEE	D. B. & P. DATE	GRANTEE	D. B. & P. DATE
From P91-21, 22 For 2012 173	PERKINS Lane LLC	meads Home Builders Inc	PERKINS ESTATES - PHASE I 1118	186	1	54-15	20,001 SF	Spade, Lorey A. (corr-1-24-17)	1202-415 5-23-14	Dossantos, Ananias G.	1229-605 6-12-15
174	"	"	"	4	2	"	17,832 SF	MASOKA, BILLIE E WAYNE	1211-42 9-23-14	WATKINS, DEBORAH B.	1277-91 3-16-17
175	"	"	"	"	3	"	16,503 SF	WATKINS, THOMAS MICHAEL	1212-868 10-16-14	Dimaulo, Steven	1475-234 01-18-23
176	"	"	"	"	4	"	16,503 SF	Eberhart, Eric & Amber	1441-901 02-11-22	Umphlet, Fionna Kaitlyn Daly, Jordan Ellis	1478-166 02-17-23
177	"	"	"	"	5	"	16,503 SF	LOLITA C. MCPHERSON, REGINAL E. &	1192-88 12-12-13	MCPHERSON, LOLITA C.	1192-88 For 2020'
178	"	"	"	"	6	"	16,521 SF	TROLL, Jeffrey G. & VALERIE F.	1239-565 10-23-15		
179	"	"	"	"	7	"	17,634 SF	WARD, Charles E. Barbara	1262-435 8-25-16	Simonsen, Selena D.	1502-568 12-28-23
180	"	"	"	"	8	"	21,043 SF	CROWTHER, RANDOLPH M.	1244-669 1-14-16	Northrup, Donald E. & Teresa	1401-124 03-16-21
181	"	"	"	"	9	"	19,061 SF	BANKS, ANDRAE J.	1250-119 3-29-16		
182	"	"	"	"	50	"	17,707 SF	RUSSELL, MATTHEW Adam	1174-73 5-16-13		
183	"	"	"	"	51	"	18,044 SF	TAFT, Pamela Felton	1239-688 10-27-15	Brink, Mark S. & Diana L.	1401-321 03-18-21
184	"	"	"	"	52	"	18,137 SF	LUISE BECKER SQUIRES, HILTON Kenneth E.	1234-802 8-20-15		
185	"	"	"	"	53	"	18,008 SF	DIXON, MATTHEW C.	1233-92 7-30-15		
186	"	"	"	"	54	"	17,936 SF	MUNDEN, LASHONDA M.	1230-301 6-24-15		
187	"	"	"	"	55	"	17,888 SF	Anderson, Peggy Lee	1438-220 01-05-22		
188	"	"	"	"	56	"	17,860 SF	ALEXANDER, NICOLE C.	1148-71 8-14-12		
189	"	"	"	"	57	"	17,871 SF	GILLIS, SARAH M.	1149-124 8-24-12	Acuff, David A.	1413-941 06-23-21
190	PERKINS Lane LLC	meads Home Builders Inc	8-16-11 1118	186	58	54-15	17,943 SF	VALENSKI, VICKY	1140-495 5-21-12		

PASQUOTANK COUNTY RURAL OWNERSHIP

TOWNSHIP NIXONTON INSIDE

RURAL MAP No. P91

TEMPORARY PARCEL NO.	GRANTOR RECORDED OWNER	GRANTEE RECORDED OWNER (BY DEED)	DEED OR WILL BOOK NO.	PAGE NO.	LEGAL LOT NO.	LEGAL PLAT NO.	LOT SIZE OR ACREAGE	GRANTEE	D. B. & P. DATE	GRANTEE	D. B. & P. DATE
191	PERKINS Lane LLC	meads Home Builders Inc	8-16-11 1118	186	59	54-15	18,383 SF	CORPREW, MICHAEL J. JR	1137-819 4-20-12	Rudey, Steven J.	1314-511 7-3-18
192	"	"	"	"	60	"	16,727 SF	SPENCE, JOSEPH T. SR.	1138-292 4-25-12	GUNDER, Luke & Jessica	1453-285 05-24-22
193	"	"	"	"	61	"	15,000 SF	THREL, HENRY A.	1204-302 6-17-14	STORY, BARUCH E. ISRAEL-	1300-409 12-29-17
194	"	"	"	"	62	"	16,307 SF	LAMB, Andy & Ashley Sawyer	1161-313 12-31-12		
195	"	"	"	"	63	"	15,963 SF	EICHINGER, WILLIAM G.	1159-210 12-6-12		
196	"	"	"	"	64	"	15,222 SF	WHITE, VIVIAN D.	1156-644 11-9-12		
197	"	"	"	"	65	"	15,568 SF	BARNES, WILLIAM M. & KATHLEEN	1177-774 6-25-13	CHAPPELL, Betty H.	1270-574 12-13-16
198	"	"	"	"	66	"	15,829 SF	HELMS, DANITA Gay	1177-355 6-20-13		
199	"	"	"	"	67	"	15,000 SF	MARRINER, Douglas R. & SALLY B.	1196-125 2-19-14	MULLER, Nancy B.	1281-92 5-1-17
200	"	"	"	"	68	"	15,000 SF	HOLLEY, VERONICA LEIGH & KENNETH DOUGLAS JR.	1196-687 2-27-14		
201	"	"	"	"	69	"	15,847 SF	GoyTOWSKI, Timothy C. & KATIE L.	1200-611 4-30-14	COX, MISSY	1280-631 4-27-17
202	"	"	"	"	70	"	17,983 SF	DONOHUE, MICHAEL A. & CAROL L.	1200-746 5-2-14	DONOHUE Family Revocable TRUST	1200-749 5-2-14
203	"	"	"	"	71	"	15,002 SF	CHAPPELL, Mary S.	1186-558 9-30-13	Stevenson, Martin J. & Jessica L.	1444-279 03-04-22
204	"	"	"	"	72	"	15,000 SF	KNAPP, DUSTIN ROSS &	1189-538 11-5-13	KNAPP, DUSTIN	1224-622 4-14-15
205	"	"	"	"	73	"	15,057 SF	HOSKINS, RECKIE D.	1160-628 12-21-12		
206	"	"	"	"	74	"	16,367 SF	HURDLE, Jason C.	1226-325 4-30-15		
207	"	"	"	"	75	"	15,204 SF	BRIDGERS, MORGAN B.	1169-146 3-28-13	STATE Employees Credit Union	1334-796 5-3-19
208	PERKINS Lane LLC	meads Home Builders Inc	8-16-11 1118	186	76	54-15	21,594 SF	SWAIN, KEITH Adam & Amy ELIZABETH	1177-861 6-26-13	SWAIN, KEITH Adam	1234-616 8-18-15

Carden Printing Co. 338-8452

PASQUOTANK COUNTY RURAL OWNERSHIP

 TOWNSHIP Nixonton Inside

 RURAL MAP No. P91

TEMPORARY PARCEL NO.	GRANTOR RECORDED OWNER	GRANTEE RECORDED OWNER (BY DEED)	DEED OR WILL BOOK NO.	PAGE NO.	LEGAL LOT NO.	LEGAL PLAT NO.	LOT SIZE OR ACREAGE	GRANTEE	D. B. & P.	GRANTEE	D. B. & P.
									DATE		DATE
From P91-21, 22 For 2012 209	PERKINS LAW LLC 8912963509	meads Home Builders INC	8-16-11 1118	186	77	54-15	15,000 SF	GRIFFIN, MARY B.	1173-811 5-15-13		
210	" " " " 8912964508	" " " "	" "	" "	78	"	15,030 SF	HARELL, STANAY L. SHAUN M. E.	1172-418 5-1-13	Raby, Jennifer Edmund Norris, Jr. E.	1453-100 05-23-22
211	" " " " 8912964598	" " " "	" "	" "	79	"	15,030 SF	SAWYER, George Raymond	1180-282 7-19-13	Brown, Keith L SR	1342-869 8-5-19 →
212	" " " " 8912965588	" " " "	" "	" "	80	"	15,030 SF	OVERTON, WILLIE W. E. PATRICIA Ann	1183-752 8-27-13	Wells Fargo Bank, N.A.	1303-613 2-13-18 →
213	" " " " 8912966578	" " " "	" "	" "	81	"	15,000 SF	KERN, GINA M.	1221-755 3-4-15	Preiser-Harris Whitney Lee Harris, Boyd Randall	1437-398 12-28-21
214	" " " " 8912959787	CITY OF ELIZABETH CITY	8-9-12 1147	601	Pump Station	"	2000 SF				
215	" " " " 8912969395	PERKINS ESTATES PROPERTY OWNERS ASSOCIATION	9-16-11 1120	570	POND open space #1	"	2.66 AC				
216	PERKINS LAW LLC 8912934234	" " " "	9-16-11 1120	570	open space #2 Common Area	54-15	1.27 AC				

